

## DIGITAL VOICE RECORDER

**VN-7000  
VN-6500  
VN-6000  
VN-5500  
VN-5000**

### EN INSTRUCTIONS

Thank you for purchasing an Olympus Digital Voice Recorder. Please read these instructions for information about using the product correctly and safely. Keep the instructions handy for future reference.

To ensure successful recordings, we recommend that you test the record function and volume before use.

#### OLYMPUS IMAGING CORP.

Shinjuku Monolith, 3-1 Nishi-Shinjuku 2-chome, Shinjuku-ku, Tokyo 163-0914, Japan. Tel. +81 (0)3-3340-2111 <http://www.olympus.com>

#### OLYMPUS IMAGING AMERICA INC.

3500 Corporate Parkway, P.O. Box 610, Center Valley, PA 18034-0610, U.S.A. Tel. 1-888-553-4448 <http://www.olympusamerica.com>

#### OLYMPUS EUROPA HOLDING GMBH

(Premises/Goods delivery) Wendenstrasse 14-18, 20097 Hamburg, Germany. Tel. +49 (0)40-237730 (Letters) Postfach 10 49 08, 20034 Hamburg, Germany. <http://www.olympus-europa.com>

#### OLYMPUS IMAGING&AUDIO

KeyMed House, Stock Road, Southend-on-Sea, Essex, SS2 5QH, UK Tel. +44 (0) 1702 616333 <http://www.olympus.co.uk>

## Introduction

- The contents of this document may be changed in the future without advanced notice. Contact our Customer Support Center for the latest information relating to product names and model numbers.
- The utmost care has been taken to ensure the integrity of the contents of this document. In the unlikely event that a questionable item, error, or omission is found, please contact our Customer Support Center.
- Any liability for passive damages or damage of any kind occurred due to data loss incurred by a defect of the product, repair performed by the third party other than Olympus or an Olympus authorized service station, or any other reason is excluded.

### Safe and Proper Usage

Before using your new recorder, read this manual carefully to ensure that you know how to operate it safely and correctly. Keep this manual in an easily accessible location for future reference.

- The warning symbols indicate important safety related information. To protect yourself and others from personal injury or damage to property, it is essential that you always read the warnings and information provided.

## Getting Started

### Identification of Parts

- 1 Built-in Microphone
- 2 MIC (Microphone) jack
- 3 HOLD switch
- 4 STOP (■) button
- 5 PLAY (▶) button
- 6 ◀◀ (Rewind) button
- 7 Battery cover
- 8 FOLDER/INDEX button
- 9 EAR (Earphone) jack
- 10 Display (LCD panel)
- 11 Record/play indicator light
- 12 REC (●) button
- 13 + button
- 14 ▶▶ (Fast Forward) button
- 15 - button
- 16 DISP/MENU button
- 17 ERASE (●) button

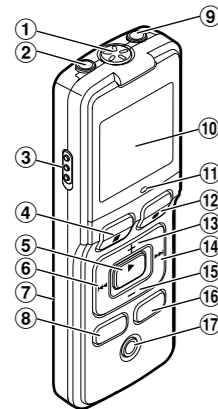

### Inserting Batteries

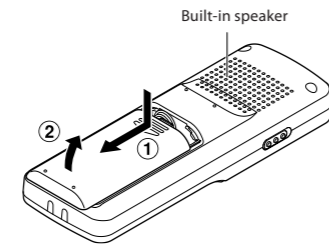

- Press down on the arrow and slide the battery cover open.

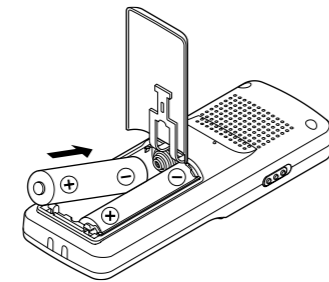

- Insert two size-AAA alkaline batteries, observing the correct polarity.

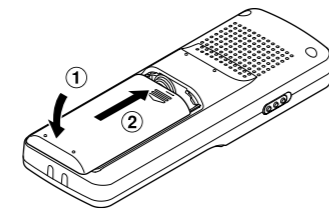

- Close the battery cover completely.
  - Time and date display appears.
  - The "Hour" indicator flashes, indicating the start of the time and date setup process. (See "Setting Time and Date [TIME]" for details).

### Replacing Batteries:

When [ ] appears on the display, replace the batteries as soon as possible. Size-AAA alkaline batteries are recommended. When the batteries are depleted, [ ] appears on the display, and the recorder shuts off. It is recommended to set the HOLD switch to the [HOLD] position before you replace batteries to maintain the current settings (Time and date, etc.). For your convenience, the recorder also logs the current settings in nonvolatile memory at hourly intervals.

An optional Ni-MH Rechargeable Battery (BR401) from Olympus can be used for the recorder.

### Power Supply

The HOLD switch functions as a power button. When you do not use the recorder, set the HOLD switch to the [HOLD] position while the recorder is stopped. This will power off the recorder and minimize the battery drain.

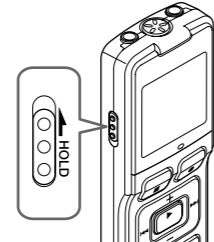

**Power on:** Reset the HOLD switch.  
**Power off:** Set the HOLD switch to the [HOLD] position.

### Standby Mode and Display Shut Off:

If the recorder is stopped or paused for 60 minutes or longer during recording or play back, it goes into Standby (power-save) mode, and the display shuts off. To exit Standby mode and turn on the display, press any button.

### Hold

Set the HOLD switch to the [HOLD] position. All operation buttons are disabled. This feature is useful when the recorder has to be carried in a handbag or pocket. Remember to reset the HOLD switch before attempting to use the recorder.

- Notes:**
- The alarm will sound at the scheduled time even if the recorder is set to [HOLD] position. The recorder will then begin to play the file associated with the alarm once you press any button.
  - The recorder functions as follows with the HOLD switch set to the [HOLD] position:
    - If the recorder is playing, the display goes dark when playback of the current file has completed.
    - If the recorder is recording, the display goes dark when the recorder stops recording automatically upon running out of free memory.

### How to Use the Strap

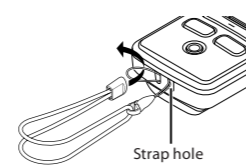

- Strap is not supplied.

### Notes on the Folders

The recorder provides four folders, [ ], [ ], [ ], and [ ]. To change the folder selection, press the FOLDER/INDEX button while the recorder is stopped. Each recorded file is stored in a folder.

- Notes:**
- Using folders to classify files makes it convenient to find files you want to access later. Up to a total of 100 files can be recorded in each folder.

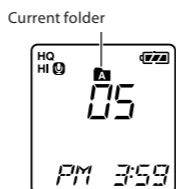

### Setting Time and Date [TIME]

If you have set the time and date, information as to when a sound file was recorded is stored automatically with that file.

When you install batteries for the first time or each time you replace the batteries, the "Hour" indication will flash. In such a case, be sure to set the time and date by following steps 1 through 7 described below.

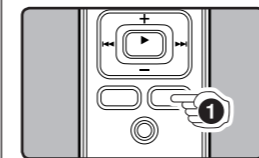

- Press and hold the DISP/MENU button for 1 second or longer.

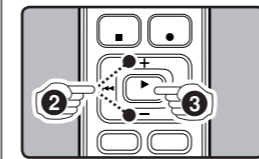

- Press the + or - button to select [TIME].
- Press the PLAY (▶) button.
  - The "Hour" indicator flashes.

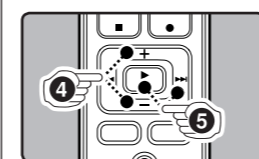
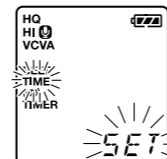

- Press the + or - button to set the "Hour".
- Press the PLAY (▶) or ▶▶ button to accept the "Minute".
  - The "Minute" indicator flashes.
  - Pressing the ◀◀ button enables the "Hour" setting again.

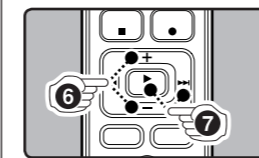
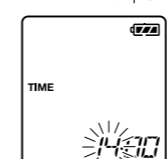

- Press the + or - button to set the "Minute".
  - Repeat steps 4 and 5 to continue to set the "Year", "Month" and "Date" in the same way.

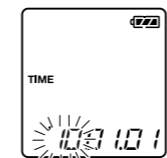

- After setting the "Date", press the PLAY (▶) or ▶▶ button.
  - This completes the time and date setup procedure.



**Notes:**

- You can switch the time indication between the 12-hour system and the 24-hour system by pressing the DISP/MENU button while you are setting the hour or minute.
- You can change the order of the date indication by pressing the DISP/MENU button while you are setting the year, month, or day.

**Example:** July 14, 2010 → 7. 14 '10 → 14. 7 '10 → '10 7. 14

## Recording

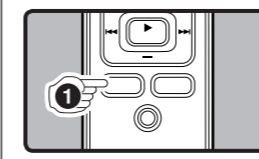

- Press the FOLDER/INDEX button to select the desired folder.
  - Current microphone sensitivity
  - Current folder

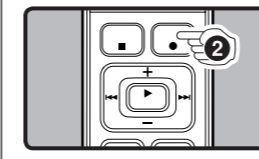
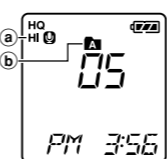

- Press the REC (●) button to start recording.
  - The record/play indicator light turns red, and recording starts.
  - Current recording mode
  - Current file number
  - Recording level meter
  - Recording time

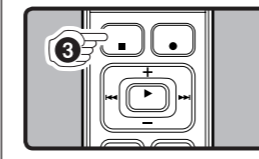
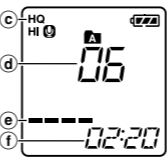

- Press the STOP (■) button to stop recording.
  - New recordings are saved as the last file in the folder.
  - Remaining recording time

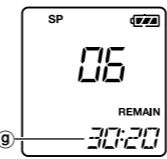

### To Pause Recording

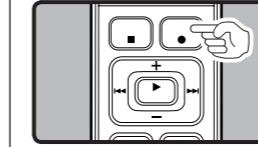

#### To Pause:

While the recorder is during recording mode, press the REC (●) button

- [PAUSE] appears on the display and the record/play indicator light flashes.

#### To Resume Recording:

Press the REC (●) button again.

- Recording will resume at the point of interruption.

### Notes for Recording

- If [FULL] appears on the display, you cannot record in the selected folder. In such a case, erase unnecessary files.
- If the recorder is placed directly on a table when recording a meeting, it tends to pick up table vibrations. Put a notebook or other item between the table and the recorder so that the vibration is not easily transmitted for clearer recording.
- Even if you press the DISP/MENU button, the display will not change to current recording time if the remaining recording time is 5 minutes or less.
- When remaining recording time is less than 60 seconds, the record/play indicator light starts flashing in red. When the recording time is decreased to 30 or 10 seconds, the light flashes faster.
- The recorder will enter Stop mode if it has been left paused for 60 minutes or longer.
- In case of difficult acoustic conditions or low speaker's voice, recording in [HQ] is recommended. Also, usage of an external microphone (sold separately) could improve the quality of recordings.

### Recording from external Microphone or other Devices

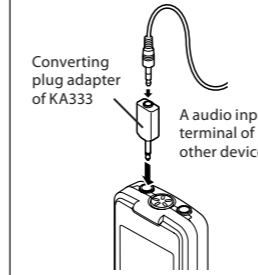

The external microphone and other devices can be connected and the sound can be recorded.

- When using an external microphone, select adequate microphone, such as a Noise-Cancellation microphone or Electret condenser microphone (optional).
- To connect the recorder to an external device, use the connecting cord KA333 (optional), and the stereo/monaural converting plug adapter supplied with KA333.
- The input level cannot be adjusted on this recorder. When you connect the recorder to an external device, execute a test recording and adjust the output level of the external device.

### LCD Display Information

You can select an option for the display of the recorder. This will help review and confirm different recorder settings and file information.

State of the recorder	Operation	Display
While in stop mode	Press and hold the STOP (■) button	The total number of files recorded in the folder and remaining recording time appears on the display.
While in record mode	Press the DISP/MENU button	The display switches between current recording time and remaining recording time.
While in stop mode or playback mode	Press the DISP/MENU button	Playing time → Remaining playing time → Recording date of the file → Recording time of the file → Playing time ...

- Notes:**
- In LP mode, if the remaining time is over 1000 hours, the time will be displayed as 999h 59m 59s.

## Playback

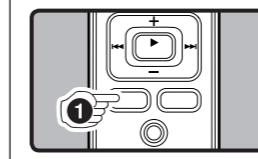

- Press the FOLDER/INDEX button to select the desired folder.
  - Current folder

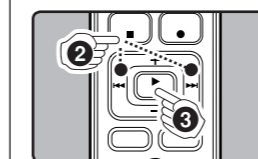
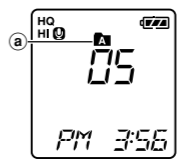

- Press the ▶▶ or ◀◀ button to select the file to playback.

- Press the PLAY (▶) button to start playback.
  - The record/play indicator light turns green, and the elapsed playing time is indicated on the display.
  - Current file number
  - Playing time

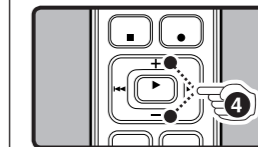
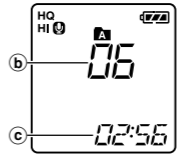

- Press the + or - button to select the proper sound volume.
  - The display shows the volume level. You can choose between [00] to [30].

### Canceling Playback

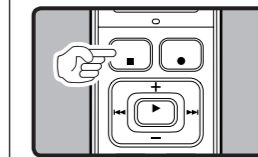

- To Stop:**
- Press the STOP (■) button.
- The recorder stops in the middle of the file being played.

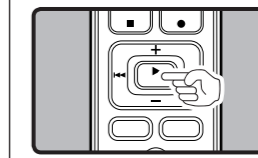

- To Resume Playback:**
- Press the PLAY (▶) button again.
- Playback will resume at the point of interruption.

### Forwarding and Rewinding

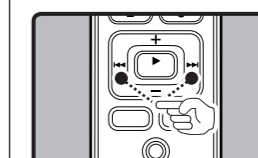

- Fast Forward:**
- While the recorder is during playback mode, press and hold the ▶▶ button.
- When you release the ▶▶ button, the recorder will resume normal playback.

- Rewind:**
- While the recorder is during playback mode, press and hold the ◀◀ button.
- When you release the ◀◀ button, the recorder will resume normal playback.

- Notes:**
- The end of the file is located by pressing and holding the ▶▶ button during fast forwarding. The recorder will pause at the end of the file. If you do not release the ▶▶ button, the recorder will continue to fast forward.
  - The beginning of the file is located by pressing and holding the ◀◀ button during rewinding. The recorder will pause at the beginning of the file. If you do not release the ◀◀ button, the recorder will continue to rewind.
  - When the index mark is shown in the middle of a file, it will stop temporarily in the position of the index mark.

### Locating the Beginning of the File:

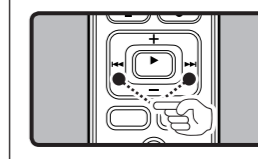

While the recorder is during playback mode (playback or playback in slow/fast mode), press the ▶▶ or ◀◀ button forwards or rewinds to the beginning of the next file or the file being played respectively.

- Note:**
- If an index mark is encountered midway, playback begins at that point. (See "Index Marks" for details)

### Changing Playback Speed:

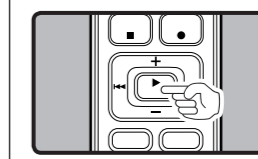

- While the recorder is during playback mode, press the PLAY (▶) button.
- Normal speed → Slow Playback (-25%) → Fast Playback (+50%)

- Notes:**
- When the slow playback mode is selected, the [ ] appears and, for the fast playback mode, [ ] appears on the display while the recorder is playback.
  - The recorder stops playback when you press the STOP (■) button while playback in the slow/fast mode, or when it reaches to the end of the file. If you once press the STOP (■) button and start playback again, the recorder will playback files in normal speed as well.

### Listening with Earphone

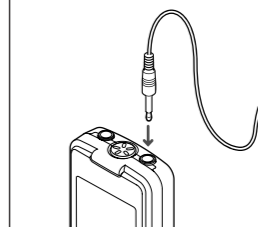

You can listen to files by connecting earphones to the earphone jack. If an earphone is connected, the speaker doesn't emit sound. Sound will be played back monaurally.

**Notes:**

- To avoid irritation to the ear, insert the earphone after you turn down the volume level.
- When you listen with the earphone during playback, do not raise the volume too much. It may cause hearing impairment and loss in hearing ability.
- Earphones are not supplied. You can use any standard 3.5mm monaural earphone or headphone.

## Erase

You can easily erase unnecessary files. Sequential file numbers are reassigned automatically.

### Erasing One File at a Time

- Press the **FOLDER/INDEX** button to select folder.
- Press the **▶▶** or **◀◀** button to select the file to be erased.
- Press the **ERASE (●)** button.
- Press the **▶▶** or **◀◀** button to select **[YES]**.  
 (a) File to be erased
- Press the **PLAY (▶)** button.

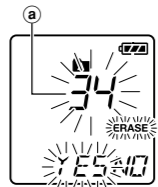

### Erase All Files from a Folder

- Press the **FOLDER/INDEX** button to select the folder to be erased.
- Press the **ERASE (●)** button twice.
- Press the **▶▶** or **◀◀** button to select **[YES]**.  
 (a) Folder to be erased
- Press the **PLAY (▶)** button.

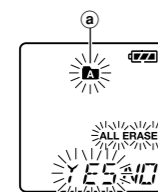

- Notes:**
- An erased file cannot be restored.
  - If operation is not executed for 8 seconds during the setting, it will return to the stop status.
  - Completion of erasing may take several seconds. Do not attempt to remove, replace battery or attempt any other functions on the voice recorder during this period because data may be corrupted.

## Menu

### Basic Operation of the Menu Mode

Using the menu function, you can change various settings according to your preference.

Menu setting screen

Move the selection one position up/increase the number

Move the selection one position to the left

Move the selection one position to the right

Confirm the setting

Move the selection one position down/decrease the number

- While the recorder is during stop mode, press and hold the **DISP/MENU** button for 1 second or longer.

- Press the **+** or **-** button to select what you would like to set up.  
 • The selected menu item flashes.
- Press the **▶▶** or **◀◀** button to change the setting.
- Press the **PLAY (▶)** button to confirm the setting.
- Press the **STOP (■)** button to close the menu.

**Notes:**

- The recorder will stop if you leave it idle for 3 minutes during a menu setup operation, when a selected item is not applied.
- If you press the **STOP (■)** button during a menu setup operation, the recorder will stop and apply the items that were set to that point.

### Recording Modes [HQ SP LP]

The recording mode can be chosen from [HQ] (high quality sound recording), [SP] (standard recording) and [LP] (long-term recording).  
**In Menu mode selection...[HQ], [SP], [LP]**

	HQ	SP	LP
<b>VN-7000</b>	Approx. 81 h.	Approx. 215 h. 50 min.	Approx. 1208 h. 30 min.
<b>VN-6500</b> <b>VN-6000</b>	Approx. 40 h. 30 min.	Approx. 107 h. 55 min.	Approx. 604 h. 15 min.
<b>VN-5500</b> <b>VN-5000</b>	Approx. 20 h. 5 min.	Approx. 53 h. 40 min.	Approx. 300 h. 30 min.

**Notes:**

- The recording time shown above is for one continuous file. The available recording time may be shorter than specified if several files are recorded. (Use the remaining time and recorded time only as references.)

### Microphone Sensitivity [HI LO]

Microphone sensitivity is adjustable to meet your recording needs.  
**In Menu mode selection...[HI], [LO]**

HI	LO
High-sensitivity mode that records sounds in all directions.	Low-sensitivity mode suited for dictation.

**Notes:**

- To ensure successful recording, make a test recording to select appropriate microphone sensitivity before recording.
- If you select [HI], we recommend setting the recording mode to [HQ] to best take advantage of the higher sensitivity.
- If you select [LO], background noise may be high depending on the recording conditions.

### Using the Variable Control Voice Actuator [VCVA]

When the microphone senses that sound has reached a preset volume, the built-in Variable Control Voice Actuator (VCVA) starts recording automatically, and stops it when the volume drops. Particularly helpful for extended recording, the VCVA not only conserves memory by turning off recording during silent periods, but also makes playback more efficient and convenient.

**In Menu mode selection...[On], [Off]**

**Notes:**

- During recording, press the + and - buttons to adjust the VCVA level in 15 levels.
- The Record/Play indicator light is lit during recording. When the recorder is in Standby mode, the Record/Play indicator light flashes and [VCVA] flashes on the display.

### System Sounds [BEEP]

Notifies a button operation or a wrong operation of the recorder by sound. System sounds may be turned off.

**In Menu mode selection...[On], [Off]**

**Note:**

- If the alarm playback function has been set, the alarm will sound at the scheduled time even if the system sounds are disabled.

### Alarm Playback Function [(●)]:

You can use the alarm playback function to sound the alarm tone for 5 minutes at the scheduled time. Within this 5 minutes, pressing any button other than the **HOLD** switch starts the recorder to playback the preselected file.

**In Menu mode selection...[SET], [On], [OFF]**  
**After selecting [SET], press the PLAY (▶) button to set the time.**

**Note:**

- With the alarm playback function, only one file can be played back. Select a file for the function before setting the time.

**To cancel an alarm playback:**

**For [(●)] in the menu mode, select [OFF] and press the PLAY (▶) button.**

**Notes:**

- Regardless of the selected folder, once the alarm playback is set, it operates every day unless the setting is canceled.
- To view the current setting, select [On], and press the **PLAY (▶)** button.
- The alarm tone stops automatically if no button is pressed within 5 minutes after the alarm starts. The file is not played back in this case.
- If the recorder has no recorded file in the selected folder, the alarm playback function is not available.
- Alarm playback occurs every day unless it is set to [OFF].

### Timer Recording [TIMER]:

You can schedule for automatic recording, specifying the start time and end time of recording. When the timer-controlled recording completes, the setting is released.

**In Menu mode selection...[SET], [On], [OFF]**  
**After selecting [SET], press the PLAY (▶) button to set the time.**

**To cancel the timer setting:**

**For the timer in the menu mode, select [OFF], and press the PLAY (▶) button.**

**Notes:**

- To view the current setting, select [On], and press the **PLAY (▶)** button.
- With this function, you can set only the start and the end time of recording. The current settings of the recording mode, microphone sensitivity, VCVA and folder are applied for the settings before you set timer-controlled recording.
- The setting exceeding the remaining recording time is not allowed.
- You can record at any time even if it is not within the specified recording duration. However, if that makes the remaining recording time insufficient for the timer-controlled recording, the recording will not complete.
- If any operation is ongoing, the timer-controlled recording is overridden.

## Other Functions

### Moving File between Folders

You can move files recorded in folders [A], [B], [C] and [D] to other folders. The moved file is added to the end of the destination folder.

- Select the file you want to transfer, and press the **PLAY (▶)** button to play it.
- While the recorder is during playback mode, press and hold the **DISP/MENU** button for 1 second or longer.
- Press the **▶▶** or **◀◀** button to select a destination folder.
- Press the **PLAY (▶)** button.  
 (a) Destination folder  
 (b) Destination number of the file

**Notes:**

- The destination folder and the number of the moved file appear on the display, and moving is completed.
- If the destination folder is full (100 files), [FULL] appears on the display, and you cannot move the file to that folder.

### Index Marks

Index marks can be placed in a file during recording or playback to provide a quick and easy way of keeping track of important sections in the file.

- While the recorder is during recording (pause recording) mode or playback mode, press and hold the **FOLDER/INDEX** button to set an index mark.  
 • An index number appears on the display.

**Clearing an Index Mark:**

While the index number appears on the display, press the **ERASE (●)** button.

**Notes:**

- Up to 10 index marks can be set in a file.
- Sequential index marks numbers are reassigned automatically.

### Resetting the Recorder [CLEAR]

This function resets the current time and other settings to their initial status. It is useful if you are having problems with the recorder, or if you want to erase the entire memory of the recorder.

- Press and hold the **STOP (■)** button and the **ERASE (●)** button for 3 seconds or longer.
- Press the **▶▶** or **◀◀** button to select **[YES]**.
- Press the **PLAY (▶)** button.  
 • If you leave the recorder untouched for 8 seconds or longer before you press the **PLAY (▶)** button in Step 3, Clear mode will be canceled, and the recorder will enter Stop mode.

## General Precautions

- Read this manual carefully to ensure that you know how to operate it safely and correctly. Keep this manual in an easily accessible location for future reference.
- The warning symbols indicate important safety related information. To protect yourself and others from personal injury or damage to property, it is essential that you always read the warnings and information provided.
  - Warning regarding data loss:**
    - Recorded content in memory may be destroyed or erased by operating mistakes, unit malfunction, or during repair work.
    - For important recorded content, we recommend you to write it down some where.
    - Any liability for passive damages or damage of any kind occurred due to data loss incurred by a defect of the product, repair performed by the third party other than Olympus or an Olympus authorized service station, or any other reasons is excluded from Olympus's liability.

## For safe and correct Usage

- Be sure to stop the recorder before replacing the battery.
- Do not leave the recorder in hot, humid locations such as inside a closed automobile under direct sunlight or on the beach in the summer.
- Do not store the recorder in places exposed to excessive moisture or dust.
- Do not use organic solvents such as alcohol and lacquer thinner to clean the unit.
- Do not place the recorder on top of or near electric appliances such as TVs or refrigerators.
- Avoid sand or dirt. These can cause irreparable damage.
- Avoid strong vibrations or shocks.
- Do not disassemble, repair or modify the unit yourself.
- Do not operate the unit while operating a vehicle (such as a bicycle, motorcycle, or go-cart).
- Keep the unit out of the reach of children.

- Batteries:**
- Warning:**
    - Batteries should never be exposed to flame, heated, short-circuited or disassembled.
    - Do not attempt to recharge alkaline, lithium or any other non-rechargeable batteries.
    - Never use any battery with a torn or cracked outer cover.
    - Keep batteries out of the reach of children.
  - If you notice anything unusual when using this product such as abnormal noise, heat, smoke, or a burning odor:
    - remove the batteries immediately while being careful not to burn yourself, and;
    - call your dealer or local Olympus representative for servicing.

## Troubleshooting

- Q1: Nothing happens when a button is pressed.**  
**A1: The HOLD switch may be set to [HOLD] position. The batteries may be depleted.**  
**The batteries may be inserted incorrectly.**
- Q2: No sound or quiet sound is heard from the speaker while playing back.**  
**A2: The earphone plug may be plugged into the recorder. The volume may be set to the minimum level.**

- Q3: Recording is not possible.**  
**A3: By pressing the STOP (■) button repeatedly while the recorder stops, check if the display shows:**
- The remaining recording time in the selected folder may have reached [00:00].
  - The number of files is 100.
- Check if the display shows [FULL] by pressing the **REC (●)** button.
- Q4: The playback speed is too fast (slow).**  
**A4: The recorder may be set to fast (slow) Playback.**

## Specifications

- Recording medium:** Built-in flash memory
- Overall frequency:**  
 HQ mode: 200 to 7,900 Hz  
 SP mode: 300 to 4,700 Hz  
 LP mode: 300 to 2,900 Hz
- Recording time:**  
**VN-7000: 2 GB**  
 HQ mode: Approx. 81 h.  
 SP mode: Approx. 215 h. 50 min.  
 LP mode: Approx. 1208 h. 30 min.  
**VN-6500/VN-6000: 1 GB**  
 HQ mode: Approx. 40 h. 30 min.  
 SP mode: Approx. 107 h. 55 min.  
 LP mode: Approx. 604 h. 15 min.  
**VN-5500/VN-5000: 512 MB**  
 HQ mode: Approx. 20 h. 5 min.  
 SP mode: Approx. 53 h. 40 min.  
 LP mode: Approx. 300 h. 30 min.
- Microphone:** Electret Condenser Microphone (monaural)
- Battery life is measured by Olympus. It varies greatly according to the type of batteries used and the conditions of use.
  - Your recorded contents are for your personal use or pleasure only. It is prohibited to record copyrighted material without permission of the copyright holders according to copyright law.
  - Specifications and design are subject to change without notice for improvement of performance.
- Speaker:** Built-in ø 28 mm round dynamic speaker
- Maximum power:** 120 mW
- Earphone jack (monaural):** ø 3.5 mm diameter, impedance 8 Ω
- Microphone jack (monaural):** ø 3.5 mm diameter, impedance 2 kΩ
- Power supply:** Two AAA (LR03) batteries or Two Ni-MH rechargeable batteries
- Continuous battery:** Alkaline batteries: Approx. 39 h. Ni-MH rechargeable batteries: Approx. 22 h.
- Dimensions:** 102 (L) mm x 36 (W) mm x 20.5 (T) mm (without protrusions)
- Weight:** 63 g (including battery)

## Accessories (Optional)

- Ni-MH Rechargeable Battery Charger:** BU-400 (Europe only)
- Ni-MH Rechargeable Battery:** BR401
- Connecting cord (Earphone jack ↔ Microphone jack):** KA333
- Noise-Cancellation microphone:** ME52
- Electret condenser microphone:** ME15
- Telephone pickup:** TP7

### For customers in North and South America

- USA RFI:**  
 This equipment has been tested and found to comply with the limits for a Class B digital device, pursuant to part 15 of the FCC Rules. These limits are designed to provide reasonable protection against harmful interference in a residential installation. This equipment generates, uses and can radiate radio frequency energy and, if not installed and used in accordance with the instructions, may cause harmful interference to radio communications. However, there is no guarantee that interference will not occur in a particular installation. If this equipment does cause harmful interference to radio or television reception, which can be determined by turning the equipment off and on, the user is encouraged to try to correct the interference by one or more of the following measures:
- Reorient or relocate the receiving antenna.
  - Increase the separation between the equipment and receiver.
  - Connect the equipment into an outlet on a circuit different from that to which the receiver is connected.
  - Consult the dealer or an experienced radio/TV technician for help.
- Canadian RFI:**  
 This digital apparatus does not exceed the Class B limits for radio noise emissions from digital apparatus as set out in the Radio Interference Regulations of the Canadian Department of Communications.  
 Cet appareil numérique ne dépasse pas les limites de Catégorie B pour les émissions de bruit radio émanant d'appareils numériques, tel que prévu dans les Règlements sur l'Interférence Radio du Département Canadien des Communications.

### For customers in Europe

- CE** "CE" mark indicates that this product complies with the European requirements for safety, health, environment and customer protection.
- WEEE** This symbol [crossed-out wheeled bin WEEE Annex IV] indicates separate collection of waste electrical and electronic equipment in the EU countries. Please do not throw the equipment into the domestic refuse. Please use the return and collection systems available in your country for the disposal of this product.  
 Applicable Product : VN-7000, VN-6500, VN-6000, VN-5500, VN-5000
- RoHS** This symbol [crossed-out wheeled bin Directive 2006/66/EC Annex II] indicates separate collection of waste batteries in the EU countries. Please do not throw the batteries into the domestic refuse. Please use the return and collection systems available in your country for the disposal of the waste batteries.